



County Hall
Cardiff
CF10 4UW
Tel: (029) 2087 2000

Neuadd y Sir
Caerdydd
CF10 4UW
Ffôn: (029) 2087 2000

CYFLWYNIADA

Pwyllgor PWYLLGOR CRAFFU'R ECONOMI A DIWYLLIANT

Dyddiad ac amser y cyfarfod DYDD MAWRTH, 20 MEHEFIN 2023, 4.30 PM

Os gwelwch yn dda gweler ynghlwm y Cyflwyniad(au) a ddarperir yn y Cyfarfod Pwyllgor

13 **Cyflwyniadau**(*Tudalennau 3 - 16*)

Mae'r dudalen hon yn wag yn fwriadol

Pentwyn Leisure Centre

Pentwyn LC – Ground Floor Proposal

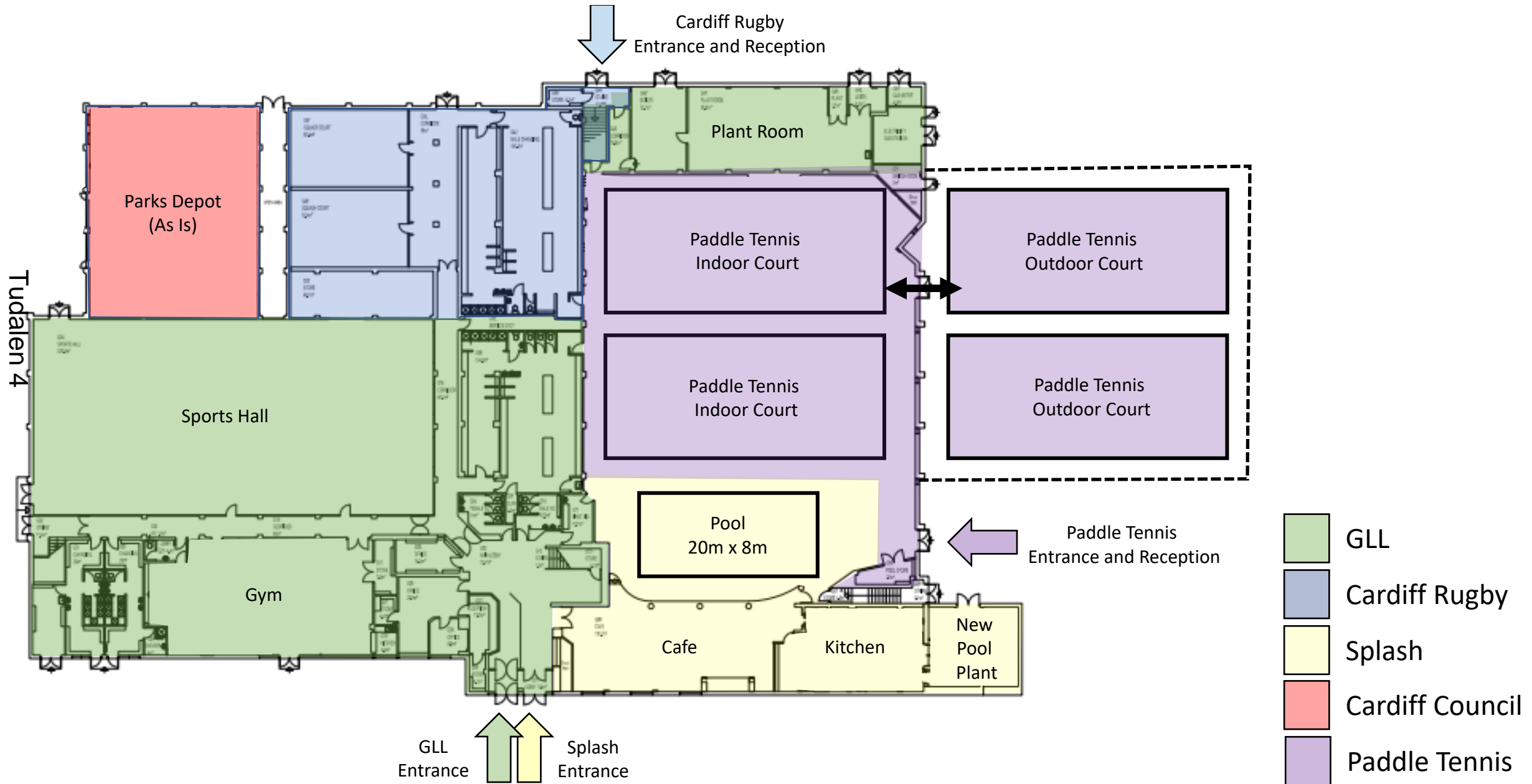

Pentwyn LC – First Floor Proposal

Tudalen 5

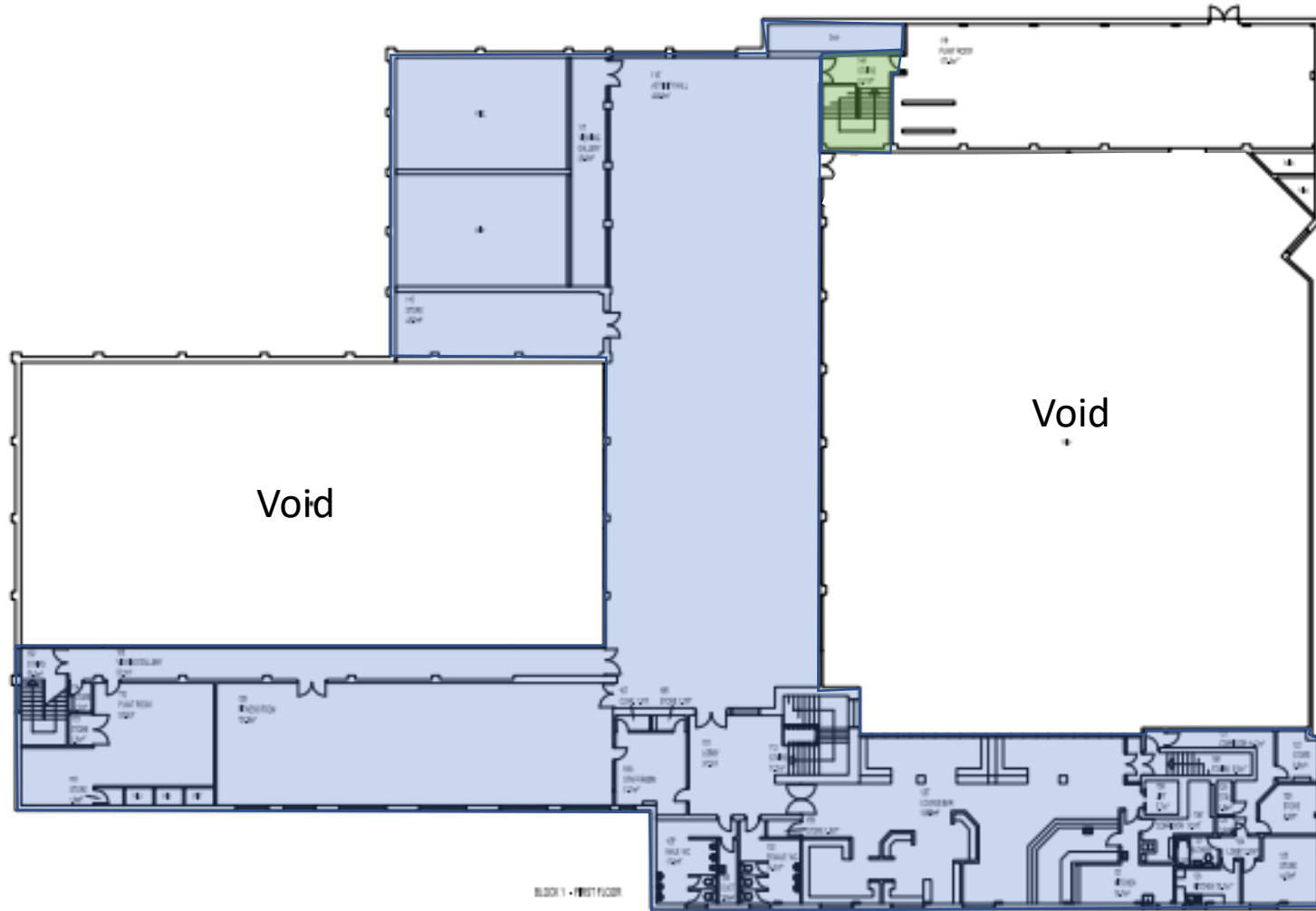

-  GLL
-  Cardiff Rugby

Pentwyn LC – External Proposal

Paddle
Tennis

Paddle
Tennis

Pentwyn Leisure Centre
Temporarily closed

Tudalen 6

Parc Coed Y Nant

New
Mini 3G

New
Full Size 3G

Upgraded
Pentwyn Dynamos
Grass Pitch



Pentwyn LC – Energy Proposal

- PLC to be part of a wider scheme to place solar panels on the roofs of all of the centres being managed by GLL.
- £900k scheme to be funded as follows:
 - £300k - Salix loan (to be repaid from the benefits)
 - £300k - GLL capital contribution
 - £200k – Council FRM allocation
 - £100k - Council maintenance contribution
- In addition, the new pool at PLC to be heated by a Ground Source Heat Pump
- The solar scheme alone is estimated to reduce the carbon footprint by 22%.

Decisions

1) **Approve the scheme** for Pentwyn Leisure Centre as outlined at Confidential Appendix 1 and Confidential Appendix 3 and delegate authority to the Director of Economic Development in consultation with the Cabinet Member for Culture, Parks and Events, the Section 151 Officer, and the Legal Officer to:

i) Deal with all aspects of the **procurement of a contractor(s)** subject to the financial envelope set out at Confidential Appendix 3;

ii) **Conclude lease agreements** with tenants on the terms set out at Confidential Appendices 3 and 4, subject to detailed due diligence and independent valuation to demonstrate best value.

1) **Approve the solar energy scheme** as set out at Confidential Appendix 5 and delegate authority to the Director of Economic Development in consultation with the Cabinet Member for Culture, Parks and Events, the Section 151 Officer, and the Legal Officer to deal with all aspects of the procurement of a contractor(s) subject to the financial envelope set out at Confidential Appendix 5.



Economy & Culture Scrutiny Committee Tennis in Parks

20/06/23

Tudalen 9



Gweithio dros Gaerdydd, gweithio gyda'n gilydd
Working for Cardiff, working together

Background



Tudalen 10

- Tennis Wales and the Lawn Tennis Association are the National Governing Bodies for tennis in the UK and Wales and have approached us seeking to invest in Cardiff Parks Tennis sites by resurfacing, lighting, introducing digital gate entry systems and tennis development activities.
- This has already been in operation successfully across the UK and is developing in our neighbouring authorities in Wales.
- The LTA have agreed with the DCMS to rollout this initiative into Wales through Tennis Wales to ensure external capital funding can reach as many communities as possible to drive participation and physical activity.
- We have a good track record in working with external partners to secure and develop outdoor parks, sports sites e.g. Victoria Park Beach Volleyball Club, Llwynfedw Gardens Pavilion, Trelai Park Pavilion and Bowls Green, Fairwater Park Changing facilities, Severn Oaks Park, St Joes Grangetown Boxing Club.
- Historically, Tennis used to be a charged activity before savings were made to remove Games Attendants from sites. At that time a court would cost in the region of £4 to hire.

Issues



- Tennis sites in Cardiff are free to use (other than Heath Park) and are in much need of Capital investment as they are falling into decline, with surfaces becoming unplayable, dangerous and becoming targets for anti social behaviour.
- Parks venues are currently under review for Trust status meaning that we will need to investigate the land ownership at each of the proposed sites and seek permission for the introduction of a management/operational agreement with Tennis Wales.
- Capital funding in Local Government is under significant pressure. Sport and Physical Activity is a discretionary service and therefore is often not the priority for capital funding allocation.
- There will not be a disposal of Public Open Space or the introduction of a Lease, instead a concession/management agreement with Tennis Wales will be agreed in order to secure the external funding.

Pricing Policy

- **Family Pass - £39.00 per annum** - Any family member in the household can book & play for 12 months, with as much tennis as they wish to play included in this fee.

e.g. A family tennis membership at Heath Park assuming 2 people play once a week for 30 weeks would equate to **£0.66p per game or £0.33p each**, compared with...

Football: **£56 per game**, Cricket: **£69 per game**, Rugby: **£76 per game**, 3G: **£76 p/h**

- **Student Pass - £19.00 per annum** - Any student can book & play for 12 months, with as much tennis as they wish to play included.
- **Pay & Play - £4.50 per court, per hour** - Simply book online, pay for the hour, and play.
- **Free** - A calendar of free trial opportunities, open days and free coaching throughout the year

N/B - The new key fob technology allows us and the LTA to record participation and usage across the city which is valuable intelligence contributing to our targets in the Physical Activity and Sport Strategy

Benefits



- This is aligned to our Physical Activity and Sport Strategy aimed at increasing activity levels, engaging communities, tackling inequality, working collaboratively with partners, reducing the burden on Public Health/NHS and creating safe places to play.
- The betterment of Mental Wellbeing and Health through activity, social interaction and enjoying the outdoor park environment.
- This fee will be managed and re invested into each site by Tennis Wales to cover the costs of maintenance, development and outreach coaching activity in schools and the local community as well as a “sink fund” to cover the resurfacing costs in the future to keep the courts playable for the long term foreseeable future.
- “Free” activities and opportunities will be included in the programme for those who are unable to pay.

Benefits cont...



- Positive engagement, sense of ownership and respect for children and young people.
- Coaching, development, fun competitions, schools engagement, holiday schemes, after dark activity which increases oversight and safety in parks and recruitment of new leaders, volunteers and coaches.
- Targeted promotions and activities for underrepresented groups will be a priority for each site through development work to improve opportunities for Women and Girls, BAME, Disability, Socially Disadvantaged and LGBTQ+.
- Ongoing investment, maintenance and care of facilities.
- Open and accessible to All.

FAQuestions



Tudalen 15

- ***Is this privatising tennis courts?***
 - No, its partnership and Tennis Wales are a part publicly funded body with similar objectives to the Council.
- ***Will low income families be excluded?***
 - No, we can demonstrate its affordability and can offer “Free” opportunities.
- ***Can we do this ourselves?***
 - No, other than Sec 106 which is not available in all wards, we have no capital funding and we no longer have the revenue budget or staff resources to deliver this
- ***How can non members book a court?***
 - People can still book a court on a “Pay as you Play” basis without needing to be a member and will be charged an hourly rate similar to the previous Council Fees and Charges.
- ***What if we do nothing?***
 - Sites will continue to deteriorate, become derelict, increased anti social behaviour, thousands of playing opportunities will be lost, external funding will be lost to other Local Authorities, poor health related to inactivity will increase.

Mae'r dudalen hon yn wag yn fwriadol